

# hydro

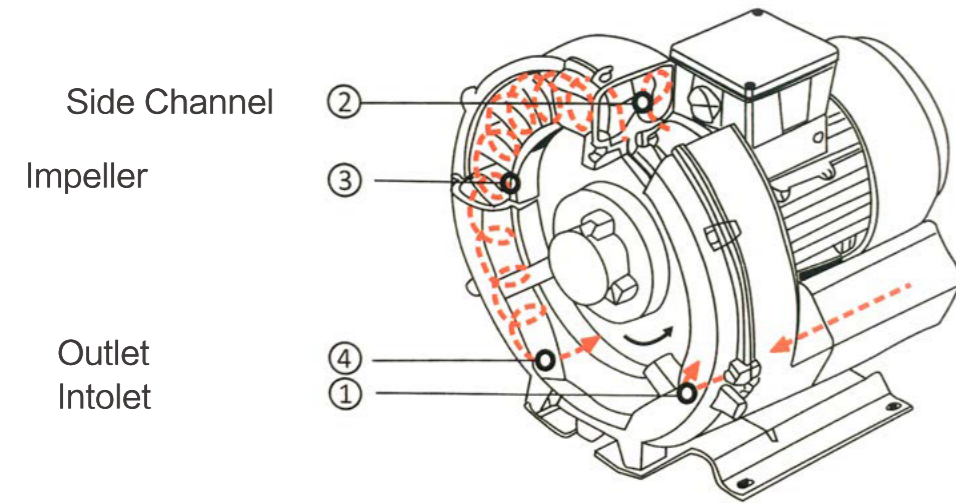

PROFESSIONAL MANUFACTURER OF  
VORTEX AIR PUMP/BLOWER PUMP/RING BLOWER

## OPERATING PRINCIPLE



The impellers are mounted directly on the motor shaft for noncontact compression entirely without friction. Maximum operational reliability, even at high differential is ensured by the arrangement of the bearings outside the compression chamber.

The gas is taken in through the inlet 1. As it enters the side channel 2, the rotating impeller 3 imparts velocity to the gas in the direction of rotation. Centrifugal force in the impeller blades accelerates the gas outward and the pressure increases. Every rotation adds kinetic energy.

Resulting in the further increase of the pressure along the side channel. The side channel narrows at the rotor, sweeping the gas off the impeller blades and discharging it through the outlet silencer 4 where it exits the side channel blower.

## VORTEX AIR PUMP EXPLOSIVE VIEW

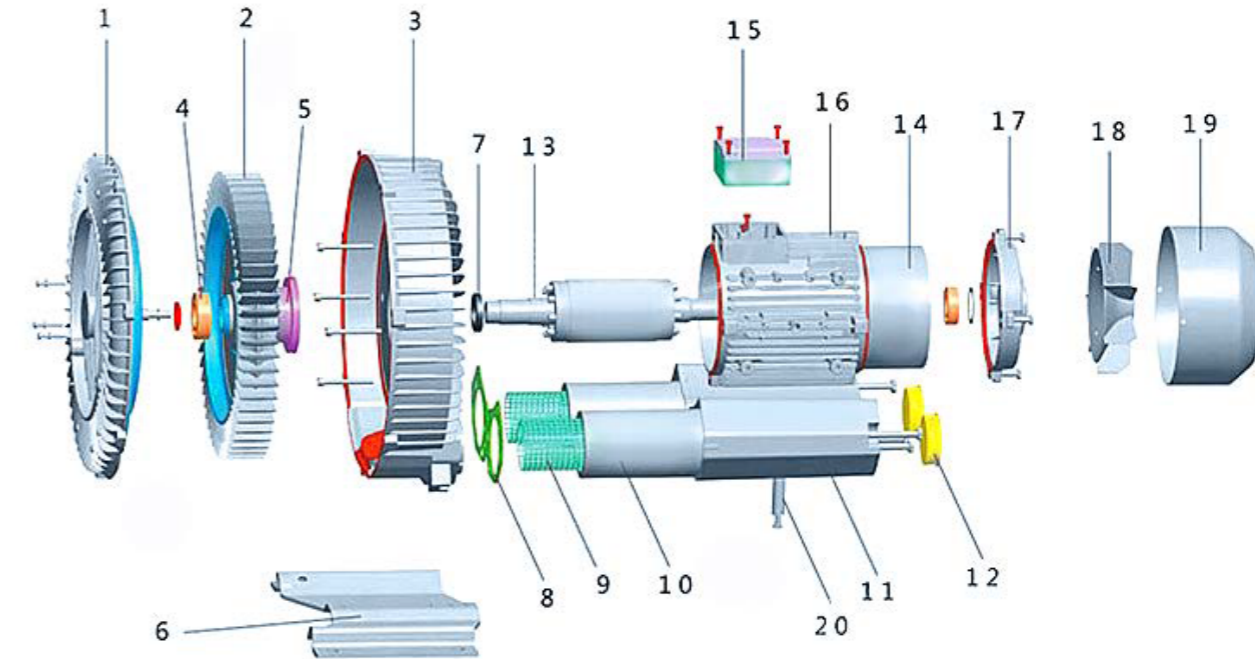

- |                 |                     |                       |                      |
|-----------------|---------------------|-----------------------|----------------------|
| 1, Pump Cover   | 6, Base plate       | 11, Silencer pipe     | 16, Motor housing    |
| 2, Impeller     | 7, Oil seal         | 12, Connector(flange) | 17, Motor end cover  |
| 3, Pump Body    | 8, Gasket           | 13, Rotor             | 18, Motor fan        |
| 4, Bearing      | 9, Silencer net     | 14, Motor             | 19, Motor back cover |
| 5, Bearing Seat | 10, Silencer sponge | 15, Terminal box      | 20, Supporting tube  |

# HIGH PRESSURE VORTEX AIR PUMP

## GB 510



Model	Rated voltage	Rated current	Frequency	Max.pressure	Max.flow	Max.vacuum	power	Speed	Noise	N.W	G.W	Packing volume
	V	A	HZ	Kpa	m <sup>3</sup> /h	Kpa	KW	r/min	dB	KG	KG	CM
GB510-1100	220	8.7(10.44)	50(60)	25(30)	210(245)	20(24)	1.1(1.3)	2800(3400)	<60	23	24.7	37x37x38
GB510-1100S	△ 220 Y380	4.36(5.88) 2.52(3.42)	50(60)	25(30)	210(245)	20(24)	1.1(1.3)	2800(3400)	<60	21.5	22.9	37x37x38
GB510-1500	220	11.8(14.16)	50(60)	26(31)	220(255)	21(25)	1.5(1.8)	2800(3400)	<60	23.4	28	37x37x38
GB510-1500S	△ 220 Y380	5.96(8.20) 3.44(4.74)	50(60)	26(31)	220(255)	21(25)	1.5(1.8)	2800(3400)	<60	22.5	26	37x37x38

GB

Performance Curve of GB Series Vortex Air pump (for reference only and not for testing basis)

### GB510-1100

● 50HZ 1.1KW ● 60HZ 1.3KW

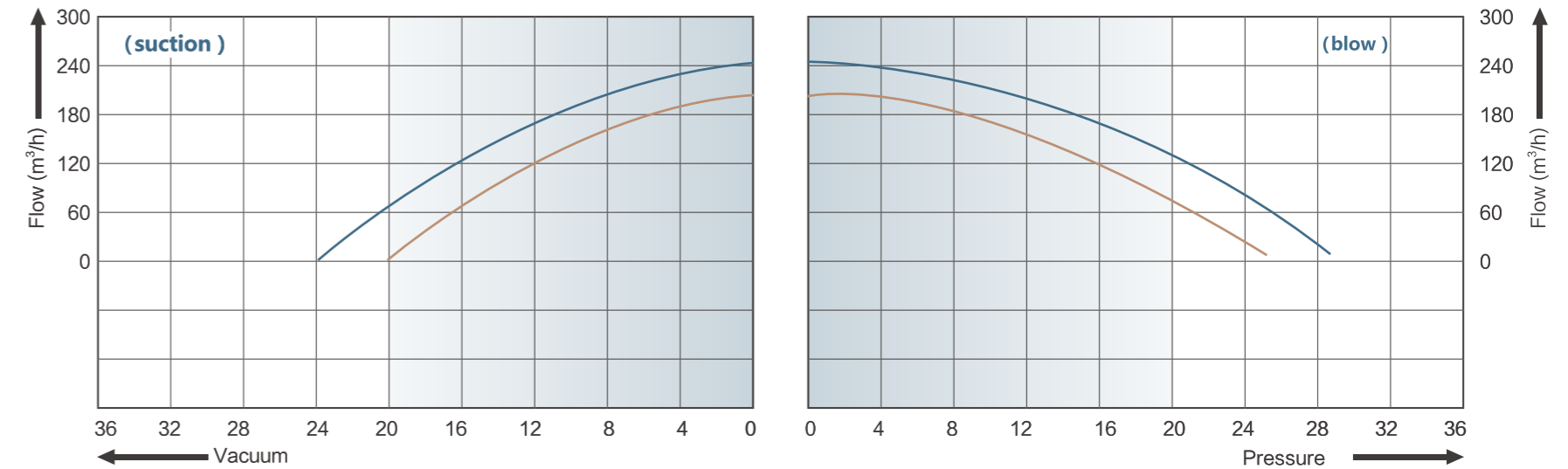

### GB510-1500

● 50HZ 1.5KW ● 60HZ 1.8KW

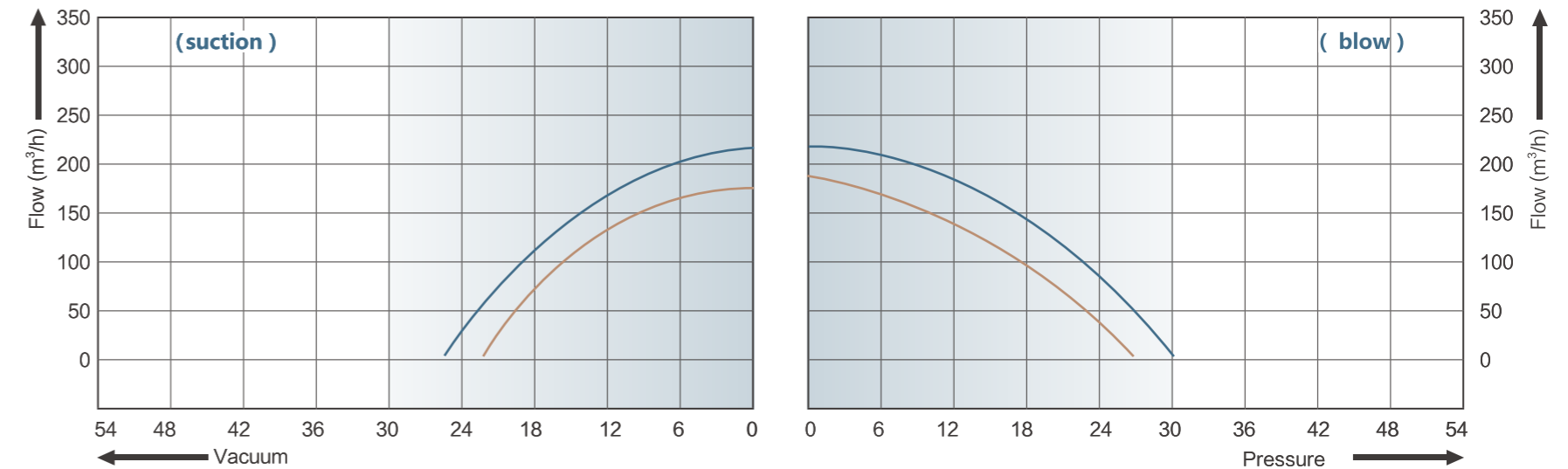

# HIGH PRESSURE VORTEX AIR PUMP

**GB 610**  
**GB 710**

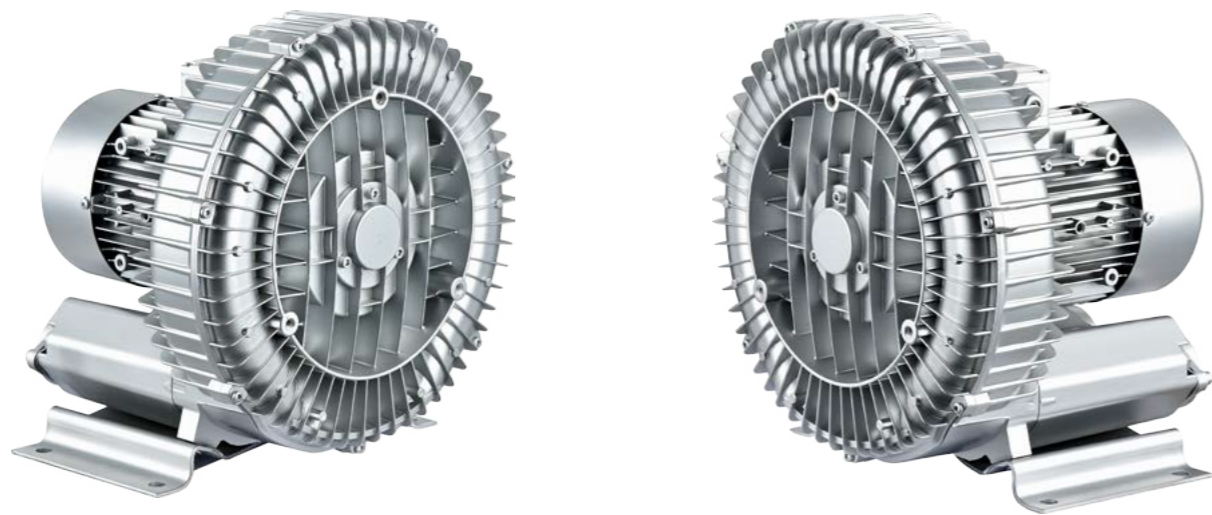

Model	Rated voltage	Rated current	Frequency	Max.pressure	Max.flow	Max.vacuum	power	Speed	Noise	N.W	G.W	Packing volume
	V	A	HZ	Kpa	m <sup>3</sup> /h	Kpa	KW	r/min	dB	KG	KG	CM
GB610-2200S	△ 220 Y380	8.52(10.22) 4.92(5.91)	50(60)	34(41)	300(340)	26(31)	2.2(2.6)	2800(3400)	<70	27	29.5	40x40x40
GB710-2200S	△ 220 Y380	8.52(10.22) 4.92(5.91)	50(60)	36(43)	325(365)	28(33)	2.2(2.6)	2800(3400)	<70	29	31.5	42x42x42

GB

Performance Curve of GB Series Vortex Air pump (for reference only and not for testing basis)

## GB610-2200

● 50HZ 2.2KW ● 60HZ 2.6KW

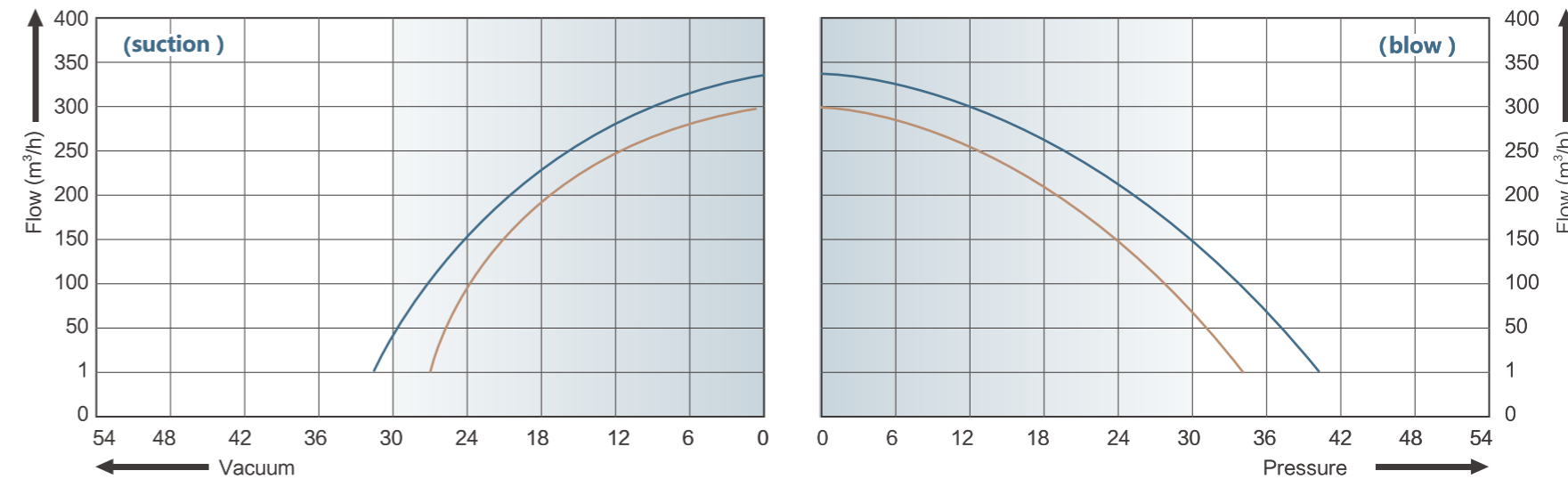

## GB710-2200

● 50HZ 2.2KW ● 60HZ 2.6KW

